

OUTPARCELS AVAILABLE STONERIDGE VILLAGE

707 Stoneridge Parkway | Jefferson City, MO 65109



PROPERTY OVERVIEW

- Located in Jefferson City, Missouri's State Capital.
- The premier retail development, situated in the core of the regional trade area.
- Ideally located just off Hwy 50 near Hwy 179.
- Outstanding access with major infrastructure improvements on Stoneridge Pkwy & Stadium Blvd.
- Area retailer's include Walmart Supercenter, Kohl's, Sams Club, Menards and Target.
- Landlord will build to suit.

DEMOGRAPHICS | 2014

	1 mile	3 miles	5 miles
Population	2,174	27,570	49,586
Households	964	12,500	21,590
Avg. Income	\$84,860	\$65,221	\$66,813

For Information Contact:

SCOTT BITNEY
314.282.9826 (direct)
314.469.7400 (office)
314.276.4673 (mobile)
Scott@L3Corp.net



707 Stoneridge Parkway | Jefferson City, MO 65109

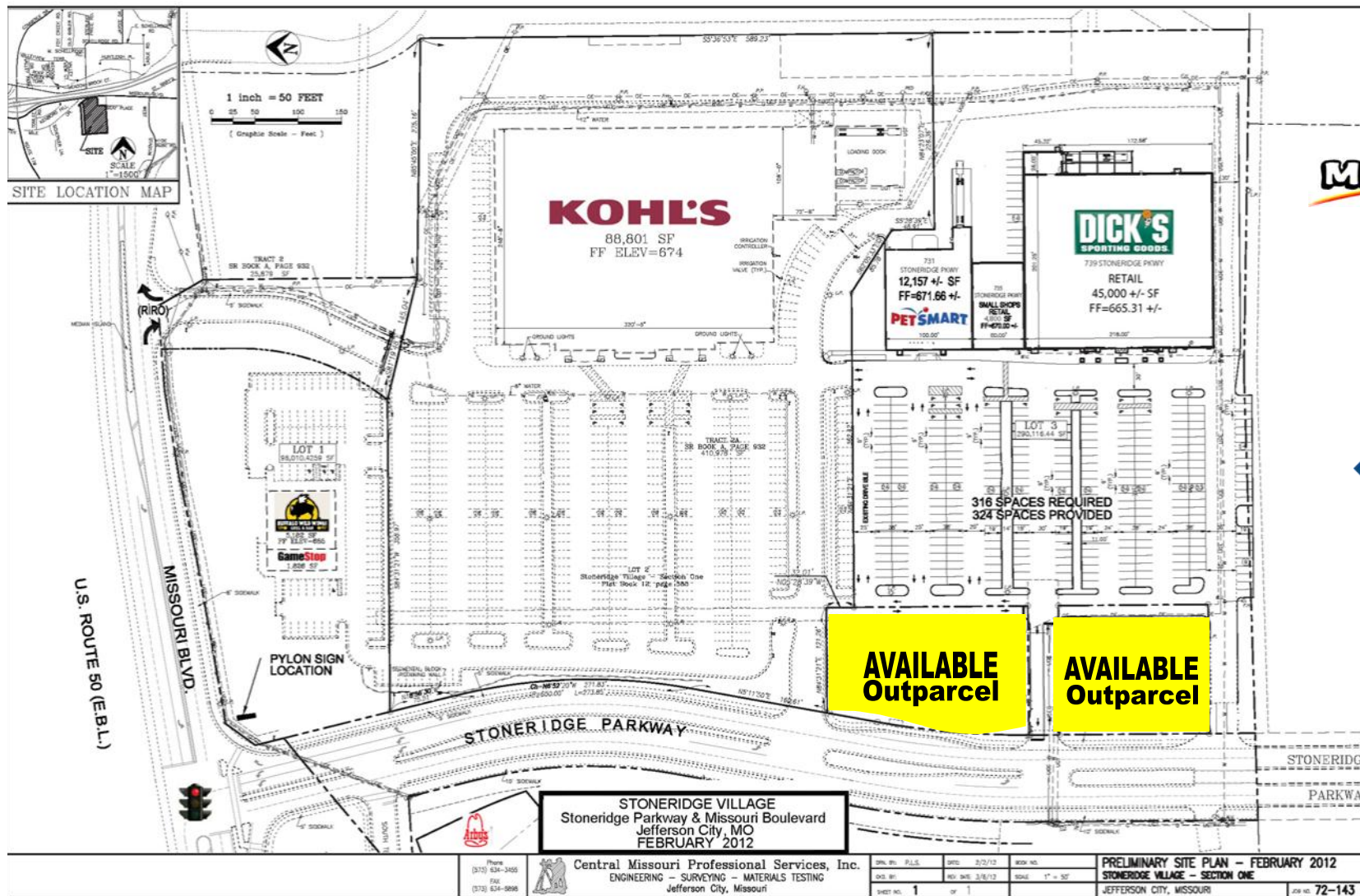

For Information Contact:

SCOTT BITNEY
314.282.9826 (direct)
314.469.7400 (office)
314.276.4673 (mobile)
Scott@L3Corp.net



L3 Corporation • 211 North Lindbergh Boulevard, Suite 150 • St. Louis, MO 63141 (t) 314.469.7400 (f) 314.576.9768 • www.L3Corp.net

The information in this flyer has been obtained from sources believed reliable. While we do not doubt its accuracy, we have not verified it and make no guarantee about it. It is your responsibility to independently confirm its accuracy and completeness. Any projections, opinions, assumptions or estimates used are for example only and do not represent the current or future performance of the property. The value of this transaction to you depends on tax and other factors which should be evaluated by your tax, financial and legal advisors. You and your advisors should conduct a careful, independent investigation of the property to determine to your satisfaction the suitability of the property for your needs.

OUTPARCELS AVAILABLE STONERIDGE VILLAGE

707 Stoneridge Parkway | Jefferson City, MO 65109

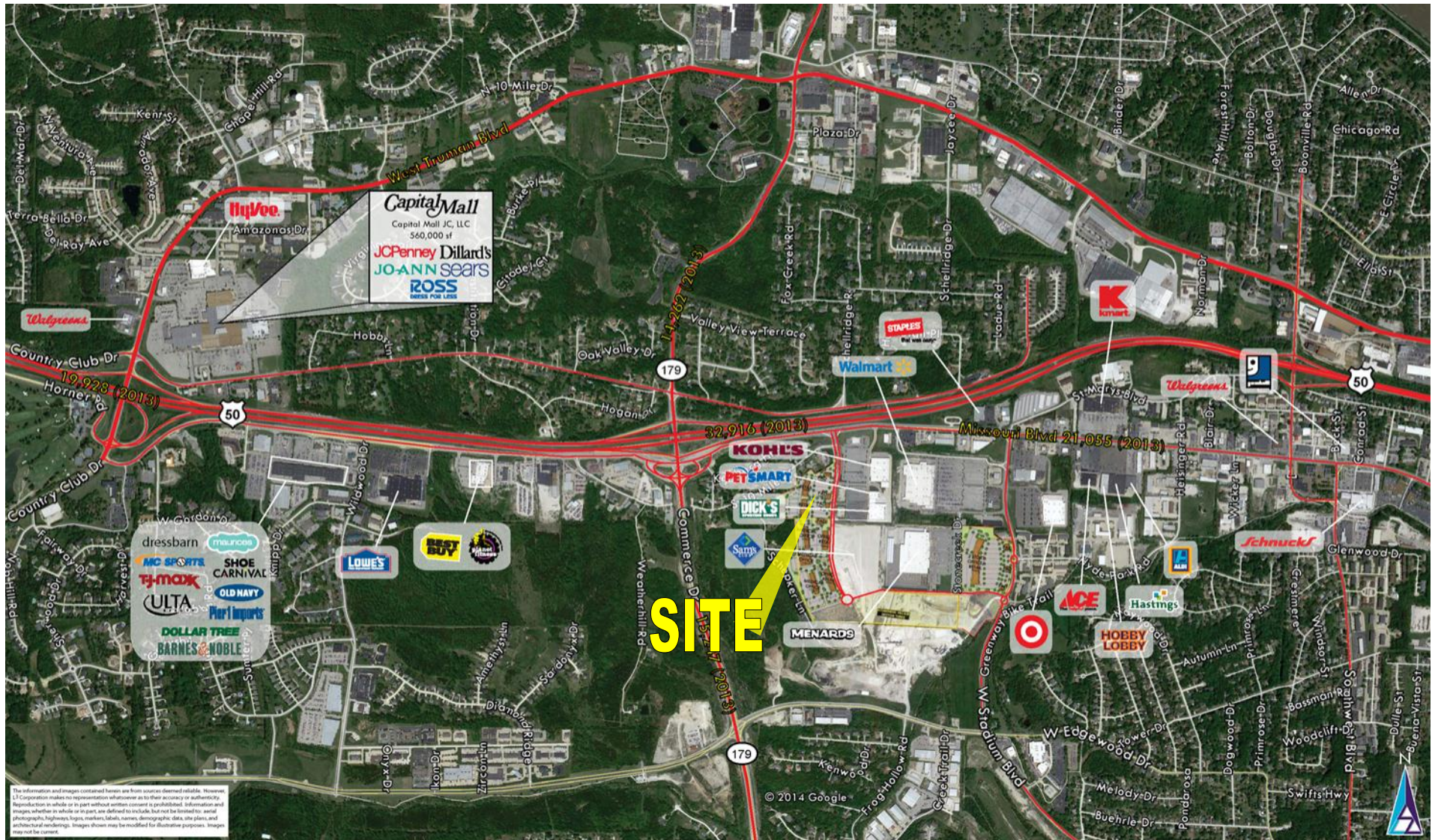

For Information Contact:

SCOTT BITNEY
314.282.9826 (direct)
314.469.7400 (office)
314.276.4673 (mobile)
Scott@L3Corp.net



L3 Corporation • 211 North Lindbergh Boulevard, Suite 150 • St. Louis, MO 63141 (t) 314.469.7400 (f) 314.576.9768 • www.L3Corp.net

The information in this flyer has been obtained from sources believed reliable. While we do not doubt its accuracy, we have not verified it and make no guarantee about it. It is your responsibility to independently confirm its accuracy and completeness. Any projections, opinions, assumptions or estimates used are for example only and do not represent the current or future performance of the property. The value of this transaction to you depends on tax and other factors which should be evaluated by your tax, financial and legal advisors. You and your advisors should conduct a careful, independent investigation of the property to determine to your satisfaction the suitability of the property for your needs.