



SITE



555 WASHINGTON AVENUE

ST. LOUIS, MO 63101

HIGH TRAFFIC, HIGH VISIBILITY RETAIL SPACE
AVAILABLE FOR LEASE IN DOWNTOWN ST. LOUIS

XTEAM
RETAIL ADVISORS



555 WASHINGTON AVENUE

SITE PLAN & DEMOS

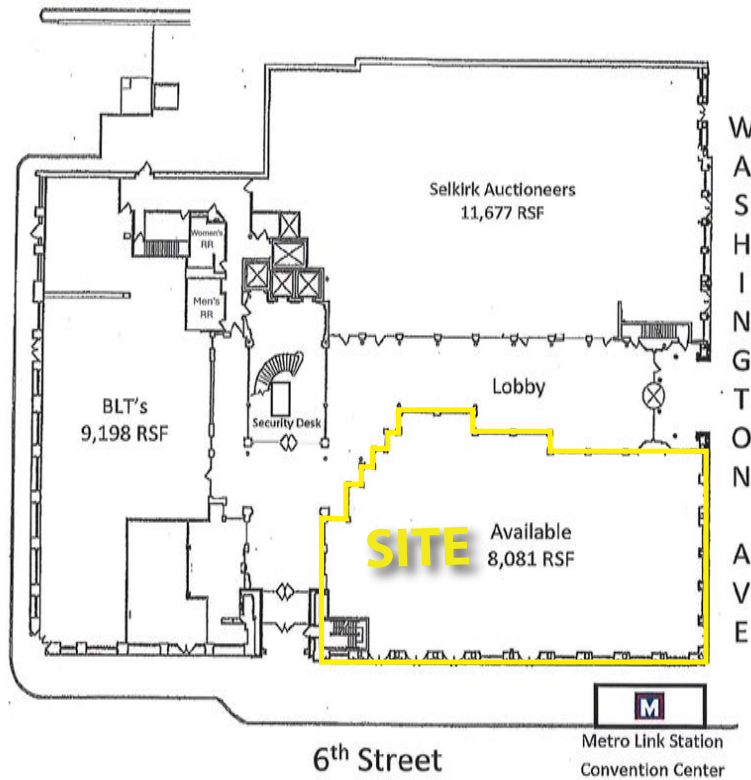
PLEASE CONTACT: L³ CORPORATION
HYLE STEINER
314.282.9835 (DIRECT)
314.313.6323 (MOBILE)
HSTEINER@L3CORPORATION.COM



POPULATION ANALYSIS

POPULATION	HOUSEHOLDS	AVG HH INCOME
 <u>1 MILE</u> 12,908	 <u>1 MILE</u> 7,398	 <u>1 MILE</u> \$76,396
<u>3 MILES</u> 67,085	<u>3 MILES</u> 32,550	<u>3 MILES</u> \$67,870
<u>5 MILES</u> 197,619	<u>5 MILES</u> 92,814	<u>5 MILES</u> \$65,891

VIEW & DOWNLOAD:

**DEMO
REPORT**

- 8,081 SF OF FIRST FLOOR RETAIL SPACE AT THE SIGNALIZED CORNER OF 6TH STREET AND WASHINGTON AVENUE
- CAN BE DEMISED TO AS LITTLE AS 2,500 SF FOR RESTAURANT TENANTS
- THE BUILDING OFFERS 24/7 PROPERTY MANAGEMENT AND SECURITY WITH ABUNDANT PARKING NEARBY AND METROLINK STATION ON SITE
- INCENTIVES AVAILABLE FOR NEW RETAILERS IN DOWNTOWN INCLUDING TENANT CONSTRUCTION DOLLARS, RENT GUARANTEES, AND SIDEWALK/PATIO IMPROVEMENT DOLLARS. LEARN MORE [HERE](#).

555 WASHINGTON AVENUE

ZOOM AERIAL

PLEASE CONTACT:

L³ CORPORATION

HYLE STEINER

314.282.9835 (DIRECT)

314.313.6323 (MOBILE)

HSTEINER@L3CORPORATION.COM



555 WASHINGTON AVENUE

MARKET AERIAL

PLEASE CONTACT:

L³ CORPORATION

HYLE STEINER

314.282.9835 (DIRECT)

314.313.6323 (MOBILE)

HSTEINER@L3CORPORATION.COM

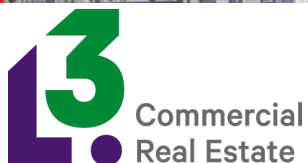
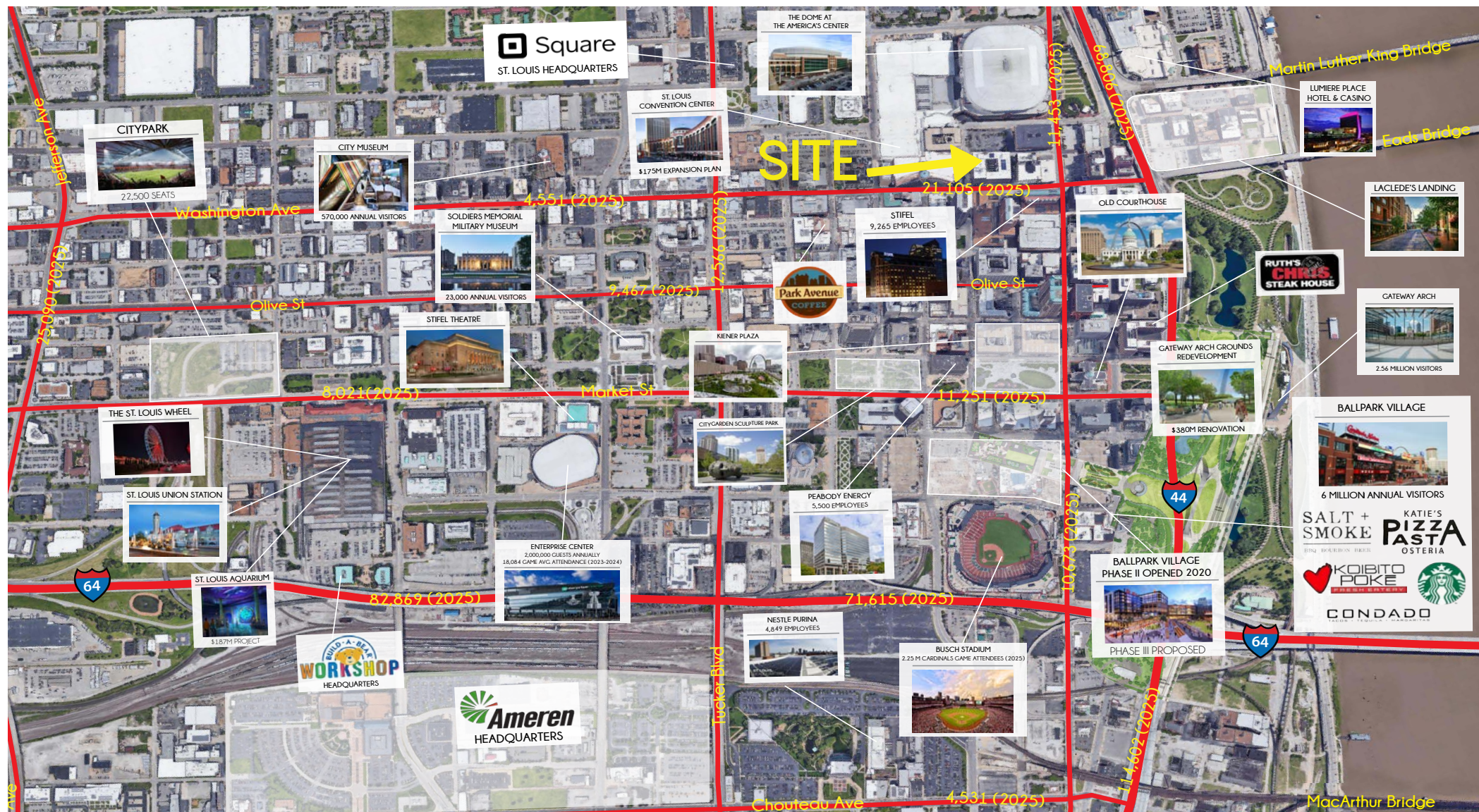

The information in this flyer has been obtained from sources believed reliable. While we do not doubt its accuracy, we have not verified it and make no guarantee about it. It is your responsibility to independently confirm its accuracy and completeness. Any projections, opinions, assumptions or estimates used are for example only and do not represent the current or future performance of the property. The value of this transaction to you depends on tax and other factors which should be evaluated by your tax, financial and legal advisors. You and your advisors should conduct a careful, independent investigation of the property to determine to your satisfaction the suitability of the property for your needs.