



DEBALIVIERE AVE 3,428 VPD (2024)

SUITE 102 SUITE 103 SUITE 108 SUITE 109 SUITE 120



## EXPO AT FOREST PARK

299 DEBALIVIERE AVENUE ST. LOUIS, MO 63112

2,098 SF TO 14,799 SF OF PREMIER RETAIL/COMMERCIAL  
SPACE AVAILABLE AT UPSCALE FOREST PARK  
URBAN APARTMENT COMMUNITY



# EXPO AT FOREST PARK

## FLOOR PLAN - NORTH BUILDING & DEMOS

PLEASE CONTACT:

LAYLA MABIE

314.282.9883 (DIRECT)

314.399.0282 (MOBILE)

LAYLA@L3CORP.NET

L<sup>3</sup> CORPORATION

RICK SPECTOR

314.282.9827 (DIRECT)

314.708.2009 (MOBILE)

RICK@L3CORP.NET

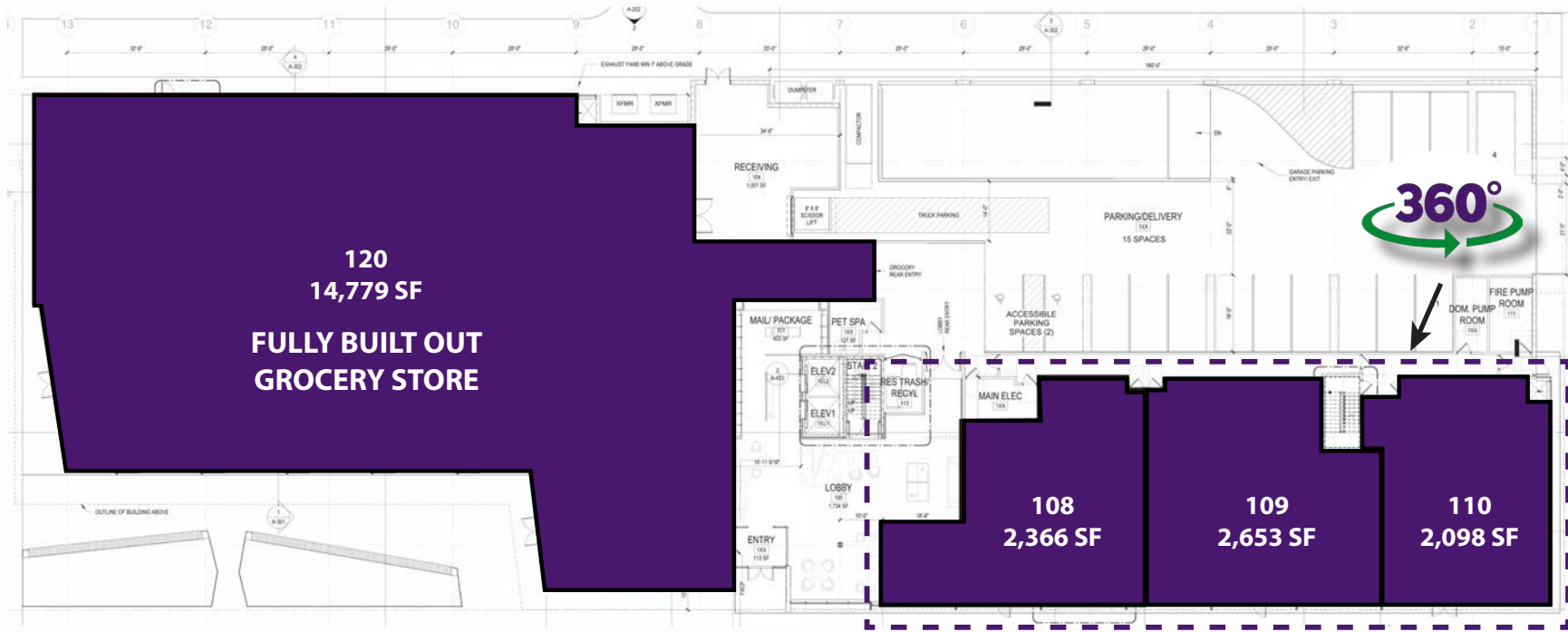



DEBALIVIERE AVE 3,428 VPD (2024)

- 2,098 SF TO 14,779 SF OF PRIME RETAIL SPACE AVAILABLE
- TURNKEY GROCERY STORE AVAILABLE
- 288 LUXURY APARTMENT UNITS WITH 361 ON-SITE PARKING SPACES
- EXCELLENT TRANSIT & PARKING ACCESS
- PREMIER LOCATION, POSITIONED BETWEEN FOREST PARK, CENTRAL WEST END, AND CLAYTON – ST. LOUIS' MOST DYNAMIC URBAN HUBS

VIEW & DOWNLOAD: **DEMO REPORT**

## POPULATION ANALYSIS

POPULATION	 1 MILE	3 MILES	5 MILES
	14,634	140,369	356,448
HOUSEHOLDS	 1 MILE	3 MILES	5 MILES
	7,463	65,781	166,665
AVG HH INCOME	 1 MILE	3 MILES	5 MILES
	\$89,143	\$106,555	\$96,938

The information in this flyer has been obtained from sources believed reliable. While we do not doubt its accuracy, we have not verified it and make no guarantee about it. It is your responsibility to independently confirm its accuracy and completeness. Any projections, opinions, assumptions or estimates used are for example only and do not represent the current or future performance of the property. The value of this transaction to you depends on tax and other factors which should be evaluated by your tax, financial and legal advisors. You and your advisors should conduct a careful, independent investigation of the property to determine to your satisfaction the suitability of the property for your needs.

# EXPO AT FOREST PARK

## FLOOR PLAN - SOUTH BUILDING

PLEASE CONTACT:

LAYLA MABIE

314.282.9883 (DIRECT)

314.399.0282 (MOBILE)

LAYLA@L3CORP.NET

L<sup>3</sup> CORPORATION

RICK SPECTOR

314.282.9827 (DIRECT)

314.708.2009 (MOBILE)

RICK@L3CORP.NET





# EXPO AT FOREST PARK

## AERIAL

PLEASE CONTACT:

LAYLA MABIE

314.282.9883 (DIRECT)

314.399.0282 (MOBILE)

LAYLA@L3CORP.NET

L<sup>3</sup> CORPORATION

RICK SPECTOR

314.282.9827 (DIRECT)

314.708.2009 (MOBILE)

RICK@L3CORP.NET

